

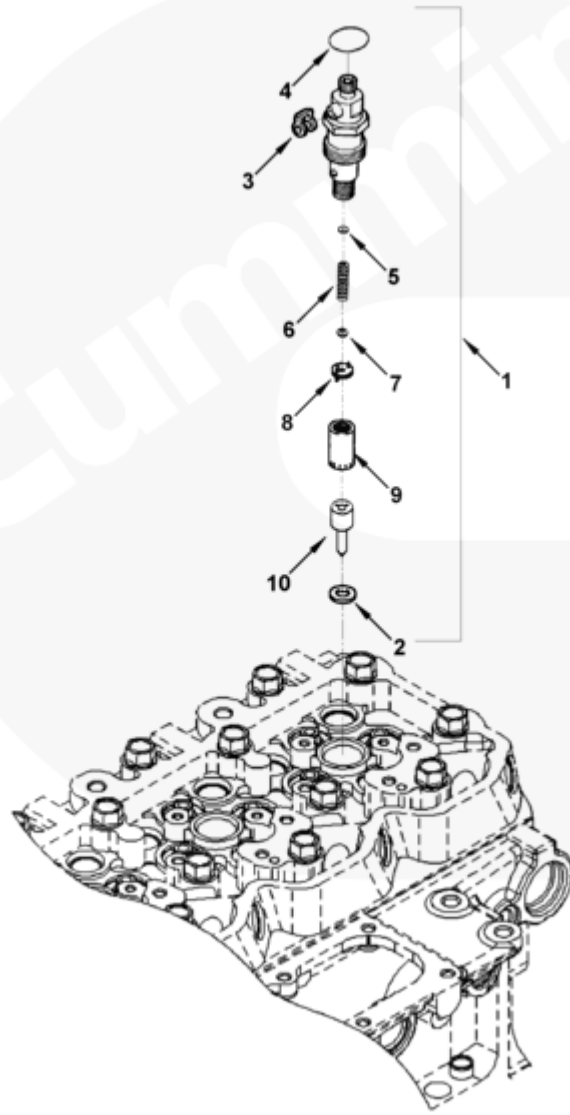

Parts Catalog - Option Detail

Electronic Parts Catalog - Option Detail				
Option	Group	Graphic	Film Card	Date
PP1322	06.01	fi900gf	T	10-MAR-92
Engines	4B3.9, 6A3.4, 6B5.9, B GAS INTERNATIONAL CM556, B4.5, B4.5 CM2350 B129B, B4.5 CM2350 B146C, B4.5 CM2350 B147B, B4.5 RGT, B4.5S, B5.9 G, B5.9 GAS PLUS CM556, B5.9 LPG, B5.9 LPG PLUS CM556, B6.7 CM2350 B121B, B6.7 CM2350 B135B, B6.7 CM2350 B136C, B6.7 CM2350 B148B, B6.7 G CMOH6.0 B125, B6.7N CM2380 B150B, B6.7S, F3.8 CM2350 F120B, F3.8 CM2350 F128C, F3.8 CM2350 F132B, F3.8 F102, G3.9, G5.9, G5.9 CM558, ISB (CHRYSLER), ISB CM2150, ISB CM2150 E, ISB CM550, ISB CM850, ISB/ISD4.5 CM2150 B119, ISB/ISD4.5 CM2150 SN, ISB/ISD6.7 CM2150 B120, ISB/ISD6.7 CM2150 SN, ISB/ISD6.7 CM2880 B126, ISB3.9 CM2220 B107, ISB4.5 CM2150, ISB5.9G CM2180, ISB6.7 2010 DCX PICKUP, ISB6.7 2013 DCX CHASSIS CAB, ISB6.7 CM2150 SQ, ISB6.7 CM2250, ISB6.7 CM2350 B101, ISB6.7 CM2350 B103, ISB6.7 CM2350 B142, ISB6.7 CM2670 B153B, ISB6.7 G CM2180 B118, ISBE CM2150, ISBE CM800, ISBE2/ISBE3 CM850, ISBE4 CM850, ISD4.5 CM2150, ISD6.7 CM2880 D101, ISF2.8 CM2220, ISF2.8 CM2220 AN, ISF2.8 CM2220 EC, ISF2.8 CM2220 ECF2, ISF2.8 CM2220 F101, ISF2.8 CM2220 F117, ISF2.8 CM2220 F122, ISF2.8 CM2220 F126, ISF2.8 CM2220 F129, ISF2.8 CM2220 IAN, ISF3.8 CM2220, ISF3.8 CM2220 AN, ISF3.8 CM2220 F103, ISF3.8 CM2220 F110, ISF3.8 CM2220 F116, ISF3.8 CM2220 F134B, ISF3.8 CM2220 IAN, ISF3.8 CM2350 F109, ISF4.5 CM2220 F123, ISG11 CM2880 G106, ISG11 CM2880 G108, ISG12 CM2880 G107, ISG12 CM2880 G109, ISG12 G CMOH6.0 G111, QSB3.9 30 CM550, QSB3.9 CM2880 B138, QSB4.5 30 CM550, QSB4.5 CM2150 B108, QSB4.5 CM2250 B131, QSB4.5 CM2250 EC, QSB4.5 CM2350 B106, QSB4.5 CM2350 B122			



f1900gf

SMALL | MEDIUM | LARGE

Cart	Ref No	Part Number	Part Description	Required	Remarks
View My Cart					
		PP1322	Fuel Injector		CPL1322
<input type="checkbox"/>	1	3802335	Injector	4	Recon equivalent 3802335 RX
		3919329	Injector	1	
<input type="checkbox"/>	2	3920174	Injector Seal	1	
	3	3903380	Banjo Connector Seal	1	Replace With 4942278
<input type="checkbox"/>	4	3909356	Rectangular Ring Seal	1	
<input type="checkbox"/>		3919358	Injector Sleeve	1	
	5	3915124	Shim	A/R	0.30 mm Thick

<input type="checkbox"/>					
<input type="checkbox"/>	5	3915125	Shim	A/R	0.42 mm Thick
<input type="checkbox"/>	5	3915126	Shim	A/R	0.44 mm Thick
<input type="checkbox"/>	5	3915127	Shim	A/R	0.46 mm Thick
<input type="checkbox"/>	5	3915128	Shim	A/R	0.48 mm Thick
<input type="checkbox"/>	5	3915129	Shim	A/R	0.50 mm Thick
<input type="checkbox"/>	5	3915130	Shim	A/R	0.52 mm Thick
<input type="checkbox"/>	5	3915131	Shim	A/R	0.54 mm Thick
<input type="checkbox"/>	5	3915132	Shim	A/R	0.56 mm Thick
<input type="checkbox"/>	5	3915133	Shim	A/R	0.58 mm Thick
<input type="checkbox"/>	5	3915134	Shim	A/R	0.60 mm Thick
<input type="checkbox"/>	5	3915135	Shim	A/R	0.62 mm Thick
<input type="checkbox"/>	5	3915136	Shim	A/R	0.64 mm Thick
<input type="checkbox"/>	5	3915137	Shim	A/R	0.66 mm Thick
<input type="checkbox"/>	5	3915138	Shim	A/R	0.68 mm Thick
<input type="checkbox"/>	5	3915139	Shim	A/R	0.70 mm Thick
<input type="checkbox"/>	5	3915140	Shim	A/R	1.00 mm Thick
<input type="checkbox"/>	5	3915141	Shim	A/R	1.28 mm Thick
<input type="checkbox"/>	5	3915142	Shim	A/R	1.56 mm Thick
<input type="checkbox"/>	6	3915123	Compression Spring	6	
<input type="checkbox"/>	7	3915122	Injector Spindle	6	
<input type="checkbox"/>	8	3915121	Intermediate Disc	6	
<input type="checkbox"/>	9	3915120	Injector Nozzle Retainer	6	
<input type="checkbox"/>	10	3919316	Nozzle	6	